

**FOR LEASE**

**5<sup>th</sup> Floor Office**

**WILLOW PROFESSIONAL BUILDING**



**JEFF NIGHTINGALE**

(604) 699-3483

[jnightingale@prospero.ca](mailto:jnightingale@prospero.ca)

**WILLOW PROFESSIONAL BUILDING**

PROSPERO  
**FOR LEASE**  
CONTACT  
JEFF NIGHTINGALE  
604-699-3483  
[www.prospero.ca](http://www.prospero.ca)

**VIDA EYECARE**  
DOCTORS OF OPTOMETRY

**TA-KE DON**  
Japanese Donburi • Salad Bar

**VEGGIE FALAFEL**

**DOMAIR**

**SHAWARMA GYRO**

**FAIRMONT OPTICAL**

**FRESH SLICE**

FOR LEASE



## LOCATION

Willow Professional Building is situated along the Broadway Corridor, on the corner of West Broadway and Willow Street. This location provides convenient access to Vancouver's major bus routes and the Canada Line. Financial institutions, hotels, restaurants and medical offices are close by. Vancouver General Hospital is one block away.



PROSPERO  
INTERNATIONAL REALTY INC.



506

# FOR LEASE

<b>UNIT</b>	506	509
<b>RENTABLE AREA</b>	1,050.2 SF	709.8 SF
<b>BASIC RENT</b>	\$17.00 /SF	\$17.00 /SF
<b>ADDITIONAL RENT</b>	\$21.19 /SF	\$21.19 /SF
<b>AVAILABLE</b>	Immediately	Immediately

**CONTACT** **JEFF NIGHTINGALE**  
 (604)699-3483  
 jnightingale@prospero.ca

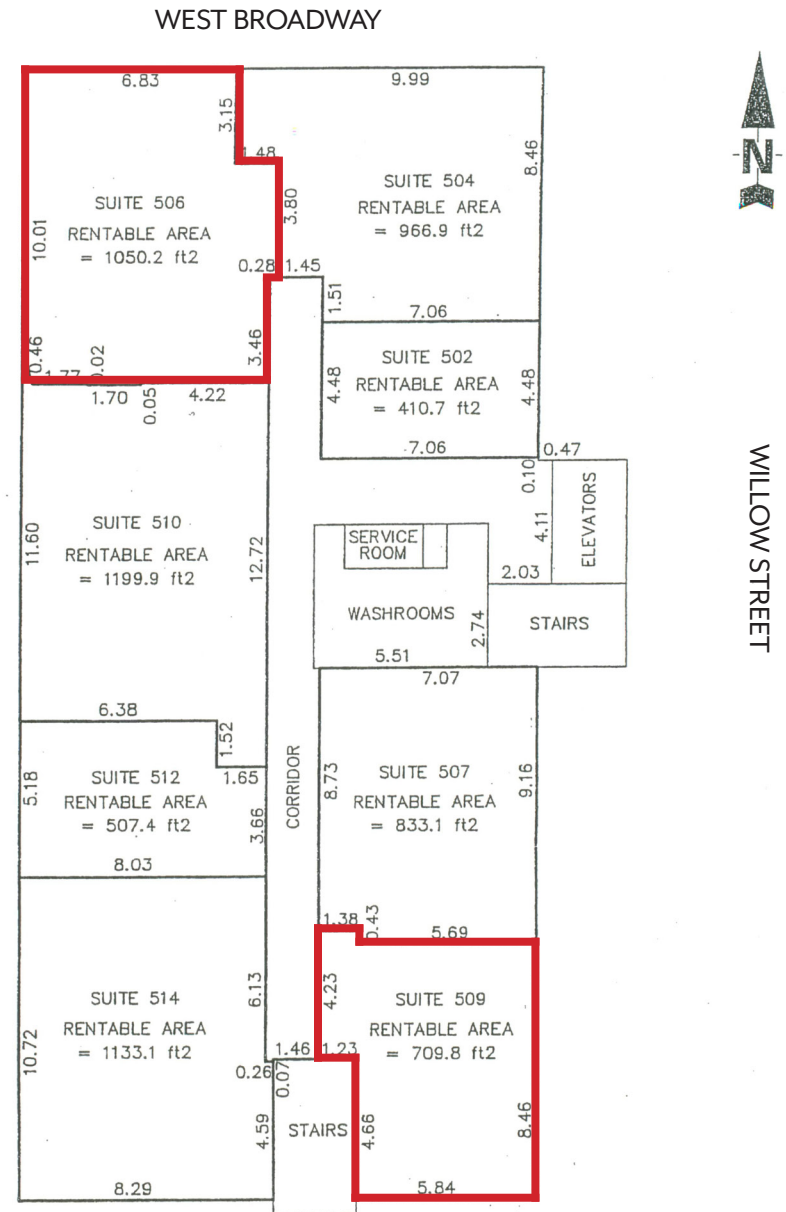

**PROSPERO**  
 INTERNATIONAL REALTY INC.

**NOTES:**  
 Common area factor (R/U Ratio) = 1.206174  
 Rentable area = Usable area x 1.206174